

**ILA-100-HD / X05 / TC / 24.5 / S**

**SERIES ILA MODEL**

Refer to product pages for available models.

- ILA = Standard In-Line Actuator
- ILAK = Keyed In-Line Actuator

**MOTOR MOUNT CODES \***

Motor Mounts Without Motor (Refer to product pages for available models.)

**NEMA Frame Mounts**

- X04 = (48C) ILA-5, ILAK-5, ILA-10, ILAK-10
- X05 = (56C) All models except ILA-200, ILAK-200
- X14 = (140TC) All models except ILA-5, ILAK-5, ILA-10, ILAK-10
- X18 = (180TC) ILA-100, ILAK-100, ILA 200, ILAK-200
- X21 = (210TC) ILA-100, ILAK-100, ILA 200, ILAK-200

**IEC Frame Mounts**

- 56B5 = ILA-5, ILAK-5
- 56B14 = ILA-5, ILAK-5
- 63B5 = ILA-10, ILAK-10
- 63B14 = ILA-10, ILAK-10
- 71B5 = ILA-10, ILAK-10, ILA-25, ILAK-25
- 71B14 = ILA-10, ILAK-10, ILA-25, ILAK-25
- 80B5 = ILA-25, ILAK-25, ILA-100, ILAK-100
- 80B14 = ILA-25, ILAK-25, ILA-100, ILAK-100
- 90B5 = ILA-100, ILAK-100
- 90B14 = ILA-100, ILAK-100
- 100B5 = ILA-100, ILAK-100, ILA0-200, ILAK-200
- 100B14 = ILA 100, ILAK-100, ILA0-200, ILAK-200

\*Unless specified at the time of order, the electric cylinder will be supplied with a jaw-type coupling that may reduce the allowable torque input. For more information please contact Nook application engineers.

**HOUSING CONFIGURATION**

T = Standard Trunnion Mount

**ROD CONFIGURATION**

- T = Threaded End
- C = Clevis End
- D = Threaded rod end with female clevis installed
- P = Top Plate

**TRAVEL**

Travel in inches

**MODIFIER LIST**

Always S, B or M

- S = Standard, no additional description required
- B = Bellows Boots (See pages 280-281)
- M = Modified, additional description required



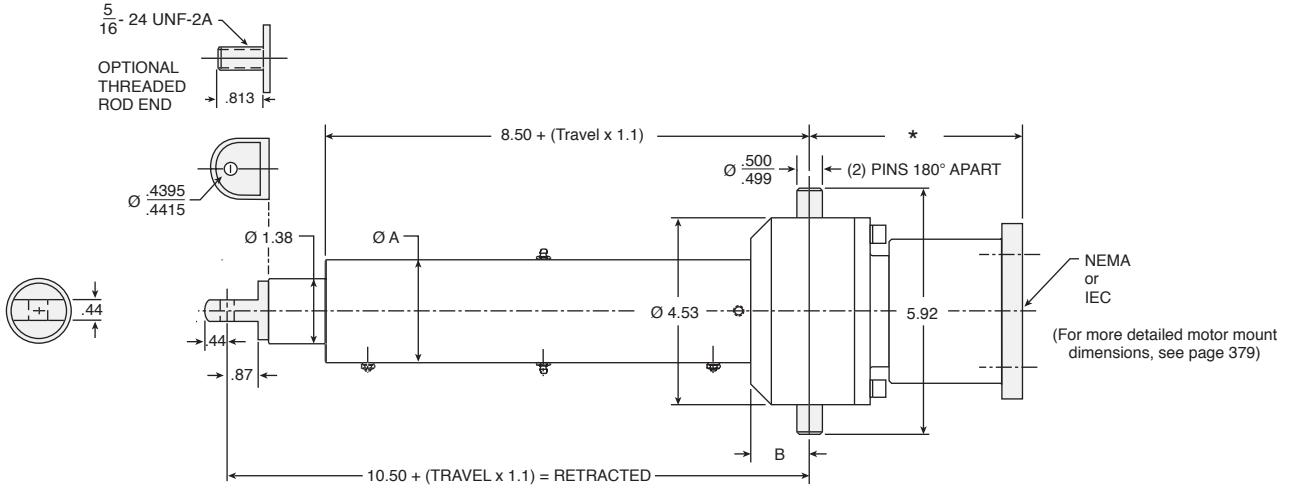

\* DIMENSION BASED ON MOTOR MOUNT, contact factory with your specific requirements.

| ILA-5 & ILAK-5 BALL SCREW MODELS |                    |                             |                             |               |                          |            |      |
|----------------------------------|--------------------|-----------------------------|-----------------------------|---------------|--------------------------|------------|------|
| MODEL NUMBER                     | MAXIMUM LOAD [lb.] | MAX. INPUT TORQUE [in.-lb.] | MAX. TRAVEL RATE [in./min.] | BALL SCREW    | TORQUE PER LB. [in.-lb.] | DIMENSIONS |      |
|                                  |                    |                             |                             |               |                          | A          | B    |
| ILA-5 HL                         | 1,000              | 88                          | 2,377                       | 0631-0500 SRT | 0.088                    | 2.25       | 1.38 |
| ILA-5 HD                         | 1,000              | 35                          | 951                         | 0631-0200 SRT | 0.035                    | 2.25       | 1.38 |
| ILAK-5 HL (Keyed)                | 1,000              | 88                          | 2,377                       | 0631-0500 SRT | 0.088                    | 3.50       | 1.10 |
| ILAK-5 HD (Keyed)                | 1,000              | 35                          | 951                         | 0631-0200 SRT | 0.035                    | 3.50       | 1.10 |

**ROD REACTION TORQUE** = TORQUE PER LB. x LOAD

**NOTE:** CYLINDER IS SELF-LOWERING. INPUT SHAFT MUST BE SECURED TO PREVENT ROTATION.

## SERIES ILA-5 & ILAK-5

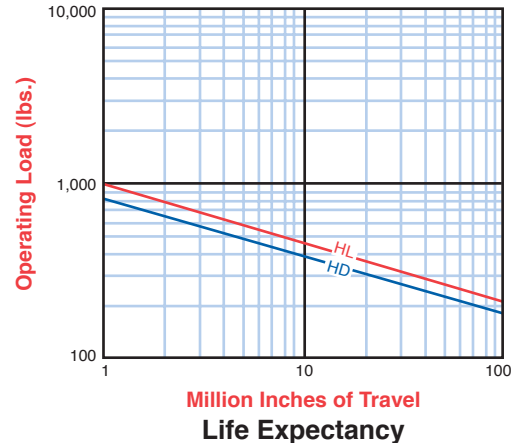
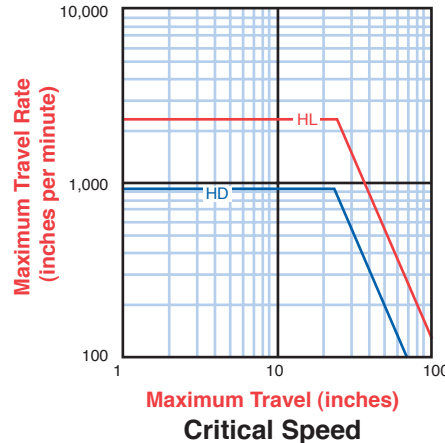
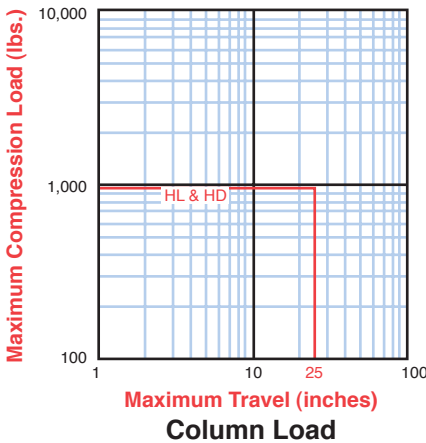

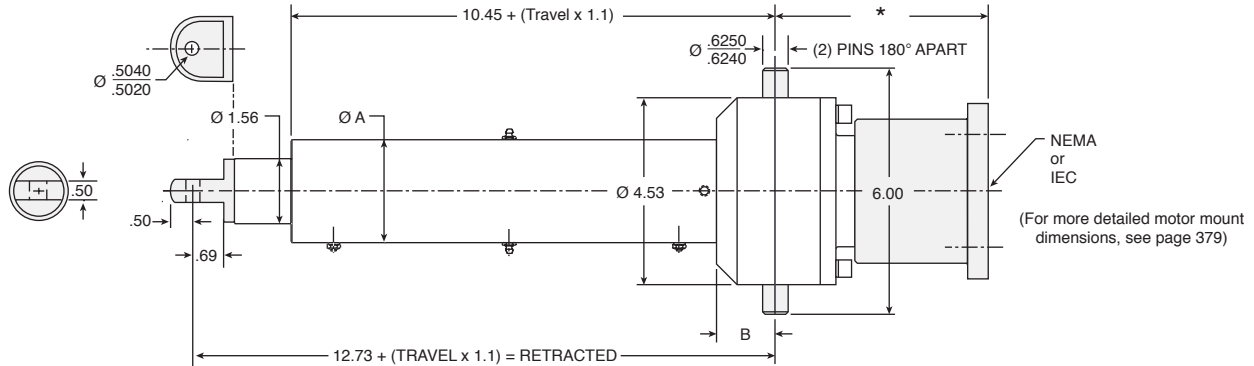
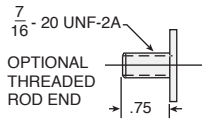

\* DIMENSION BASED ON MOTOR MOUNT, contact factory with your specific requirements.

## ILA-10 & ILAK-10 BALL SCREW MODELS

| MODEL NUMBER       | MAXIMUM LOAD [lb.] | MAX. INPUT TORQUE [in.-lb.] | MAX. TRAVEL RATE [in.-min.] | BALL SCREW    | TORQUE PER LB. [in.-lb.] | DIMENSIONS |      |
|--------------------|--------------------|-----------------------------|-----------------------------|---------------|--------------------------|------------|------|
|                    |                    |                             |                             |               |                          | A          | B    |
| ILA-10 HL          | 1,200              | 105                         | 2,000                       | 0750-0500 SRT | 0.088                    | 2.50       | 1.44 |
| ILA-10-HD          | 2,200              | 77                          | 800                         | 0750-0200 SRT | 0.035                    | 2.50       | 1.44 |
| ILAK-10 HL (Keyed) | 1,200              | 105                         | 2,000                       | 0750-0500 SRT | 0.088                    | 4.00       | 1.25 |
| ILAK-10 HD (Keyed) | 2,200              | 77                          | 800                         | 0750-0200 SRT | 0.035                    | 4.00       | 1.25 |

ROD REACTION TORQUE = TORQUE PER LB. x LOAD

## SERIES ILA-10 & ILAK-10

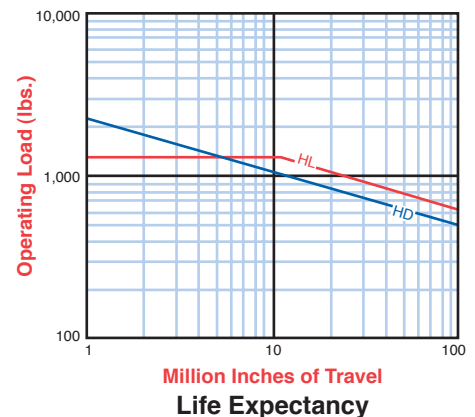
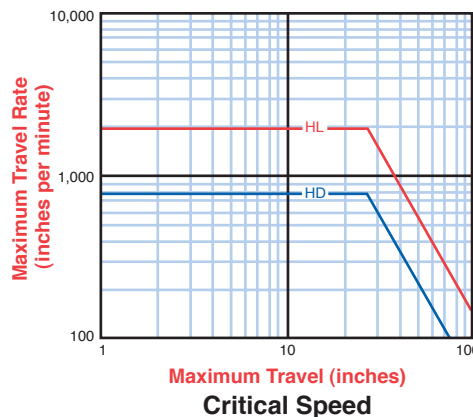
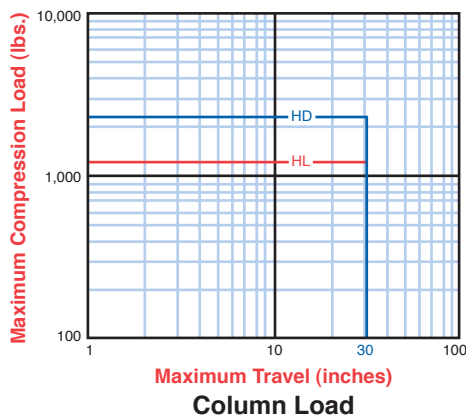

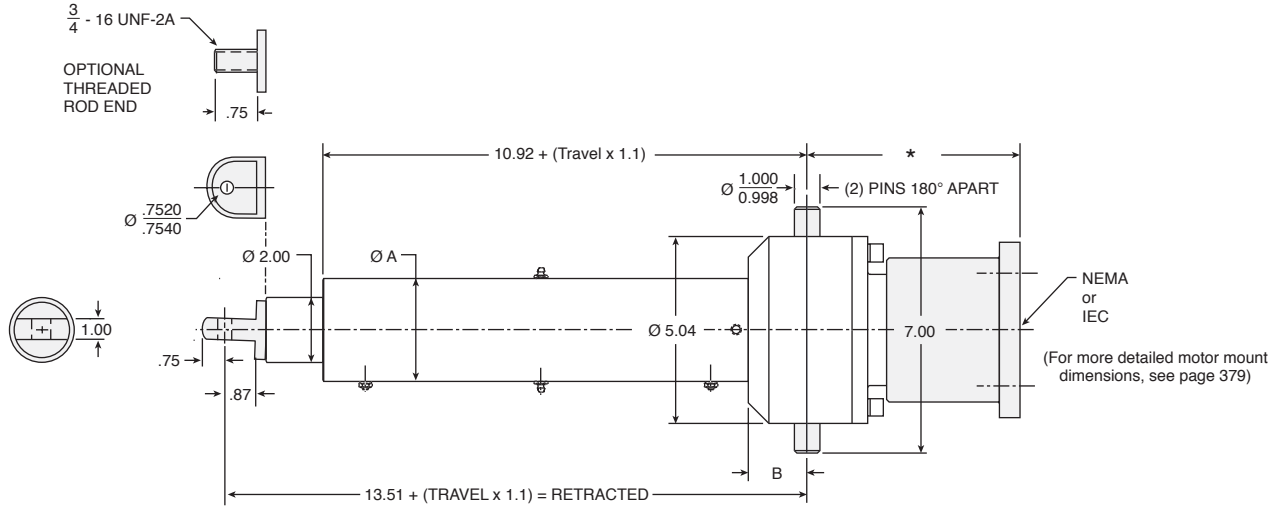

\* DIMENSION BASED ON MOTOR MOUNT, contact factory with your specific requirements.

| ILA-25 & ILAK-25 BALL SCREW MODELS |                    |                             |                             |               |                          |            |      |
|------------------------------------|--------------------|-----------------------------|-----------------------------|---------------|--------------------------|------------|------|
| MODEL NUMBER                       | MAXIMUM LOAD [lb.] | MAX. INPUT TORQUE [in.-lb.] | MAX. TRAVEL RATE [in./min.] | BALL SCREW    | TORQUE PER LB. [in.-lb.] | DIMENSIONS |      |
|                                    |                    |                             |                             |               |                          | A          | B    |
| ILA-25 HL                          | 2,200              | 390                         | 3,000                       | 1000-1000 SRT | 0.177                    | 3.00       | 1.50 |
| ILA-25-ML                          | 3,500              | 308                         | 1,500                       | 1000-0500 SRT | 0.088                    | 3.00       | 1.50 |
| ILA-25-HD                          | 3,500              | 154                         | 750                         | 1000-0250 SRT | 0.035                    | 3.00       | 1.50 |
| ILAK-25 HL (Keyed)                 | 2,200              | 390                         | 3,000                       | 1000-1000 SRT | 0.177                    | 4.00       | 1.25 |
| ILAK-25-ML (Keyed)                 | 3,500              | 308                         | 1,500                       | 1000-0500 SRT | 0.088                    | 4.00       | 1.25 |
| ILAK-25-HD (Keyed)                 | 3,500              | 154                         | 750                         | 1000-0250 SRT | 0.035                    | 4.00       | 1.25 |

**ROD REACTION TORQUE** = TORQUE PER LB. x LOAD

## SERIES ILA-25 & ILAK-25

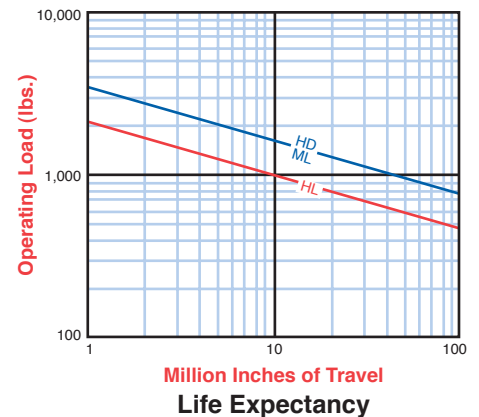
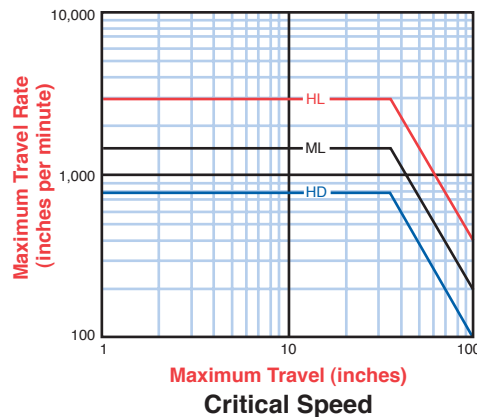
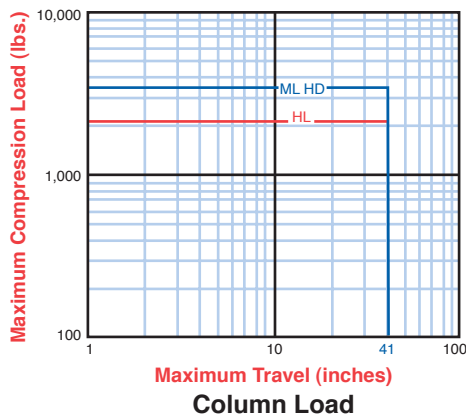

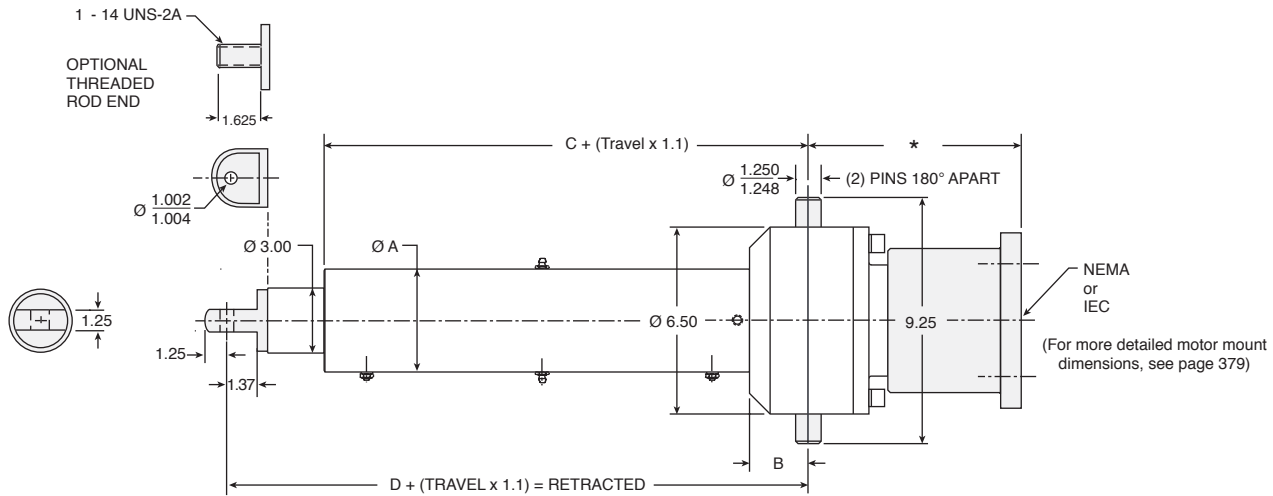

\* DIMENSION BASED ON MOTOR MOUNT, contact factory with your specific requirements.

| ILA-100 & ILAK-100 BALL SCREW MODELS |                    |                             |                             |               |                          |            |      |       |       |
|--------------------------------------|--------------------|-----------------------------|-----------------------------|---------------|--------------------------|------------|------|-------|-------|
| MODEL NUMBER                         | MAXIMUM LOAD [lb.] | MAX. INPUT TORQUE [in.-lb.] | MAX. TRAVEL RATE [in.-min.] | BALL SCREW    | TORQUE PER LB. [in.-lb.] | DIMENSIONS |      |       |       |
|                                      |                    |                             |                             |               |                          | A          | B    | C     | D     |
| ILA-100 SL                           | 2,500              | 830                         | 3,750                       | 1500-1875 SRT | 0.332                    | 4.00       | 2.50 | 16.00 | 19.00 |
| ILA-100-HL                           | 4,600              | 814                         | 2,000                       | 1500-1000 SRT | 0.177                    | 4.00       | 2.50 | 14.18 | 17.14 |
| ILA-100-HD                           | 9,000              | 756                         | 946                         | 1500-0473 SRT | 0.084                    | 4.00       | 2.50 | 14.18 | 17.14 |
| ILAK-100 SL (Keyed)                  | 2,500              | 830                         | 3,750                       | 1500-1875 SRT | 0.332                    | 6.50       | 2.00 | 17.50 | 20.50 |
| ILAK-100-HL (Keyed)                  | 4,600              | 814                         | 2,000                       | 1500-1000 SRT | 0.177                    | 6.50       | 2.00 | 14.18 | 17.14 |
| ILAK-100-HD (Keyed)                  | 9,000              | 756                         | 946                         | 1500-0473 SRT | 0.084                    | 6.50       | 2.00 | 14.18 | 17.14 |

**ROD REACTION TORQUE** = TORQUE PER LB. x LOAD

**NOTE:** CYLINDER IS SELF-LOWERING. INPUT SHAFT MUST BE SECURED TO PREVENT ROTATION.

**SERIES ILA-100 & ILAK-100**

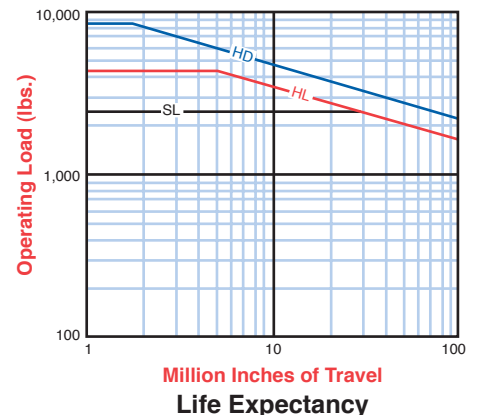
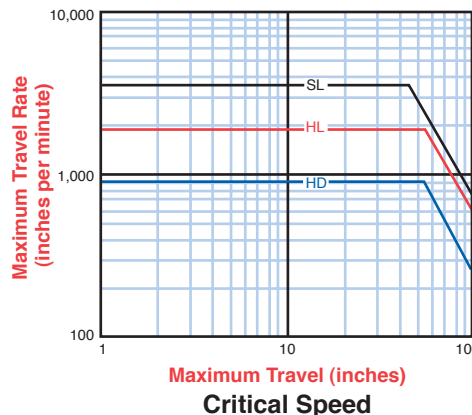
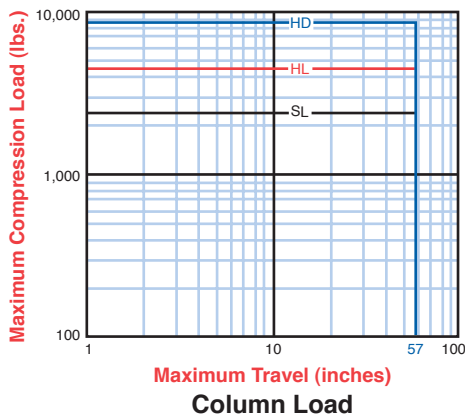

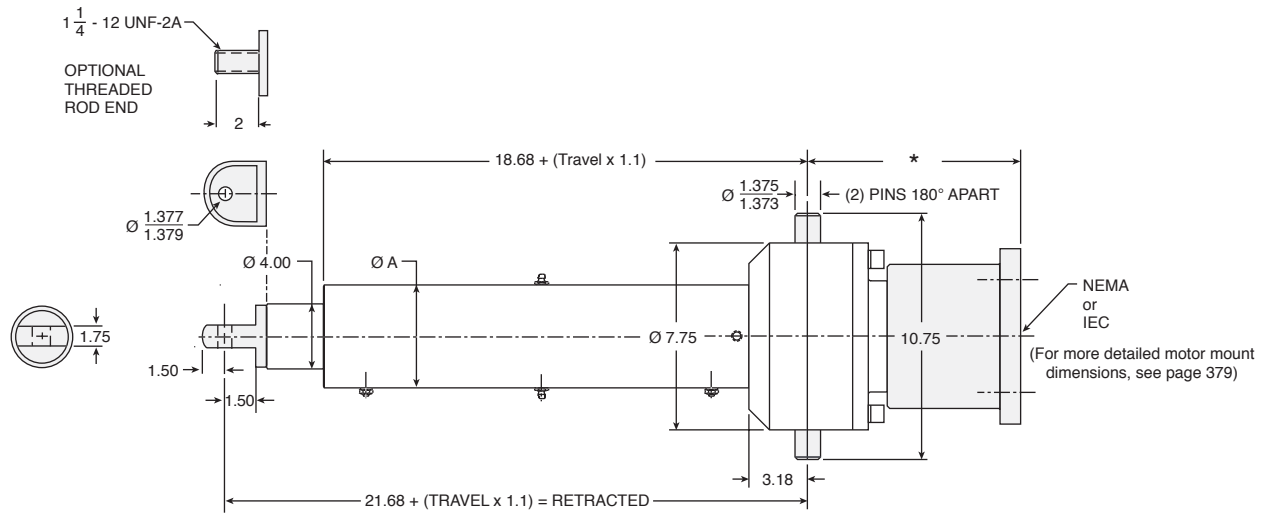

\* DIMENSION BASED ON MOTOR MOUNT, contact factory with your specific requirements.

| ILA-200 & ILAK-200 BALL SCREW MODELS |                    |                             |                             |               |                          |            |
|--------------------------------------|--------------------|-----------------------------|-----------------------------|---------------|--------------------------|------------|
| MODEL NUMBER                         | MAXIMUM LOAD [lb.] | MAX. INPUT TORQUE [in.-lb.] | MAX. TRAVEL RATE [in.-min.] | BALL SCREW    | TORQUE PER LB. [in.-lb.] | DIMENSIONS |
|                                      |                    |                             |                             |               |                          | A          |
| ILA-200 HL                           | 11,000             | 1,947                       | 1,333                       | 2250-1000 SRT | 0.177                    | 5.25       |
| ILA-200-HD                           | 21,000             | 1,848                       | 667                         | 2250-0500 SRT | 0.088                    | 5.25       |
| ILAK-200 HL (Keyed)                  | 11,000             | 1,947                       | 1,337                       | 2250-1000 SRT | 0.177                    | 7.50       |
| ILAK-200 HD (Keyed)                  | 21,000             | 1,848                       | 667                         | 2250-0500 SRT | 0.088                    | 7.50       |

**ROD REACTION TORQUE** = TORQUE PER LB. x LOAD

**NOTE:** CYLINDER IS SELF-LOWERING. INPUT SHAFT MUST BE SECURED TO PREVENT ROTATION.

**SERIES ILA-200 & ILAK-200**

