

## MESH

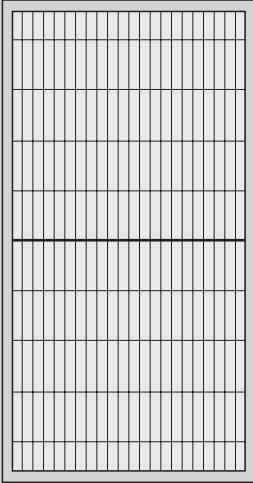

### 22x100 mesh panel

It can be produced with frame 20x20 or 30x30

Compatible with systems  
Basic, Strong and Green Fast



## SHEET PANEL

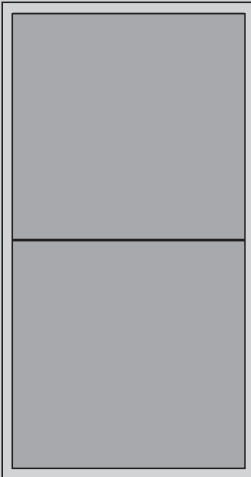

### Sheet panel

Sheet panel with thickness 1.2 mm. It can be produced with frame 20x20 or 30x30.

### Self standing shaped sheet panel

Shaped sheet panel with thickness 1.2 mm.

Compatible with systems  
Basic, Strong and Green Fast



## TRANSPARENT SHEET

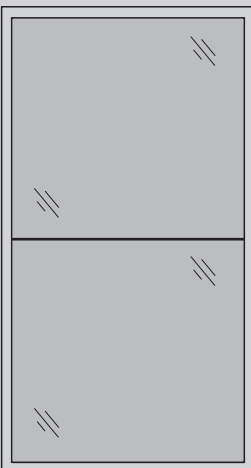

Panel in an extremely tough transparent material with 4mm thickness. It can be produced with frame 20x20 or 30x30.

Compatible with systems  
Basic, Strong and Green Fast

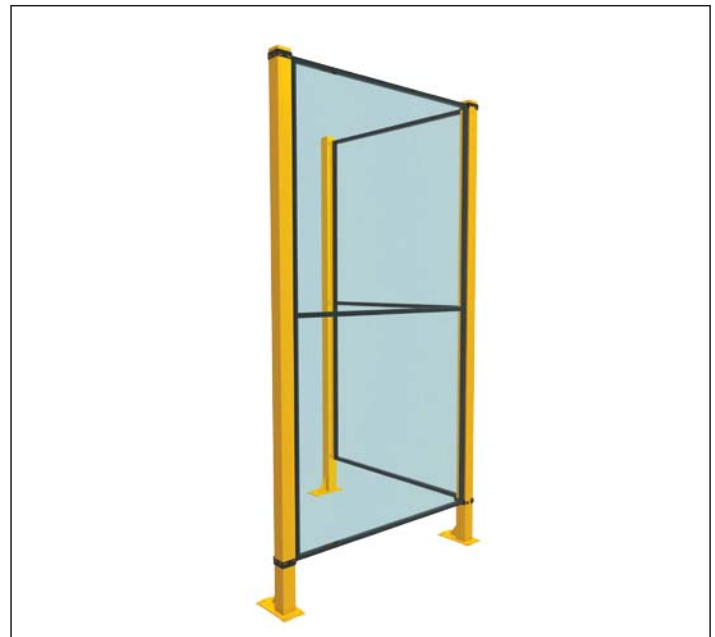

## SHEET METAL + TRANSPARENT SHEET

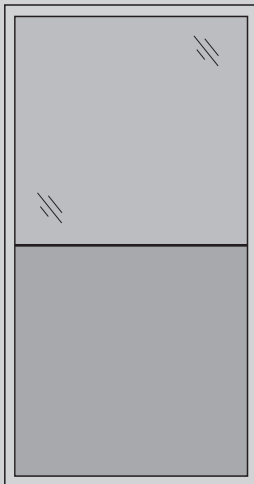

Panel in extremely tough transparent material with thickness 4 mm. and 1.2 mm thick sheet. It can be produced with frame 20x20 or 30x30 e 30x30.

Compatible with systems  
Basic, Strong and Green Fast



## SHEET METAL + MESH

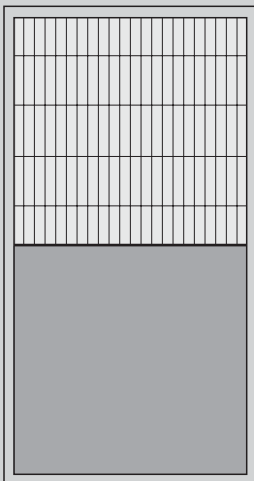

22x100 mesh panel and 1.2 mm. thick sheete. It can be produced with frame 20x20 or 30x30.

Compatible with systems  
Basic, Strong and Green Fast



## MESH + TRANSPARENT SHEET

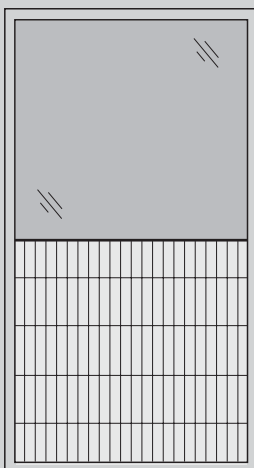

22x100 mesh panel and extremely tough transparent material with thickness 4 mm. It can be produced with frame 20x20 or 30x30

Compatible with systems  
Basic, Strong and Green Fast



## SHEET METAL + PORTLIGHT

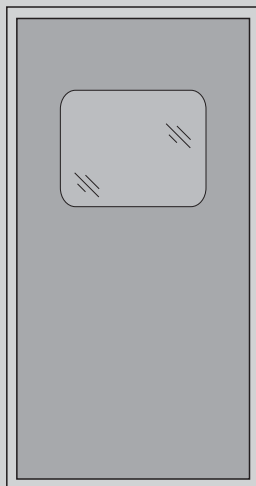

Sheet panel with 1.2 mm thickness with portlight gasket. It can be produced with frame 20x20 or 30x30.

Compatible with systems  
Basic, Strong and Green Fast



## GASKET

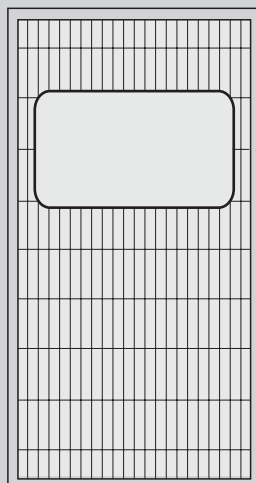

On request, a special **rubber gasket** is supplied as **useful finishing**, after having obtained an opening in the panel by cutting the mesh wires **on the assembly site**.

Compatible with all  
SATECH systems



## SHAPED

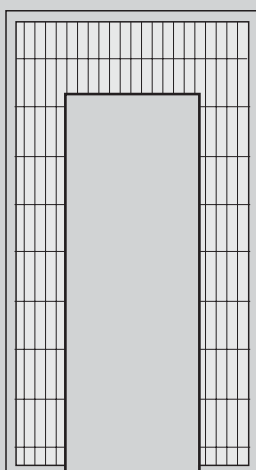

Thanks to its **department for special products**, SATECH produces **shaped panels** according to the customers' specific requirements with extremely short delivery times

Compatible with all  
SATECH systems

